

Product lineup



Product image



TD159A(CM)



TD159A(CM)-AT

Product name	Torque [N·m] (lb·in)	Damping direction
TD159A1-7K(CM)	0.7N·m(6.2lb·in)	CW
TD159A1-7K(CM)-AT		

Features

- Anti-rust type with chromate treatment is also available (CM-Type)
- Larger opening angle (280 degrees)
- The most popular damper design
- Using the attachment, the form of TD159 will be the same as TD99 (AT-Type)

Product specifications

Durability

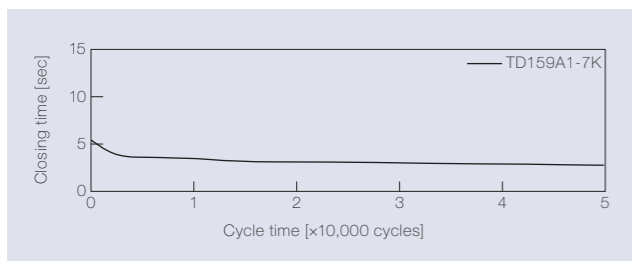

Torque	0.7N·m (6.2lb·in)
Radial load	N/A
Angle range of closing time	70 to 0 deg.
Temperature	23 ± 2°C (73.4 ± 35.6°F)
Durability	50,000 cycles

Temperature characteristics

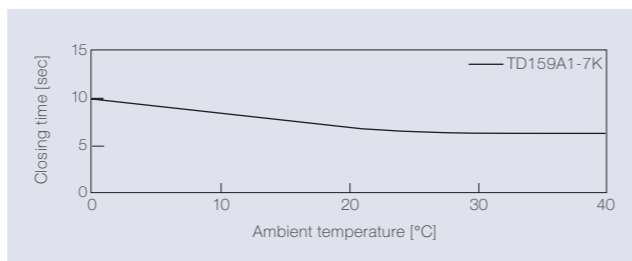

Measured according to the performance management testing method shown below after leaving in each designated ambient temperature for over one hour.

Performance management testing method

As the torque of partial rotation angle dampers is not consistent, the closing time measurement jig is used for the performance tests.

[Operation during measurement]
(Secures the housing of a rotary damper and moves its shaft)
All rotary dampers are managed by the following closing time test.

Test mode [110° → 70° (Pause) → (Free fall with damping) → 0°]
* Horizontal plane: 0°

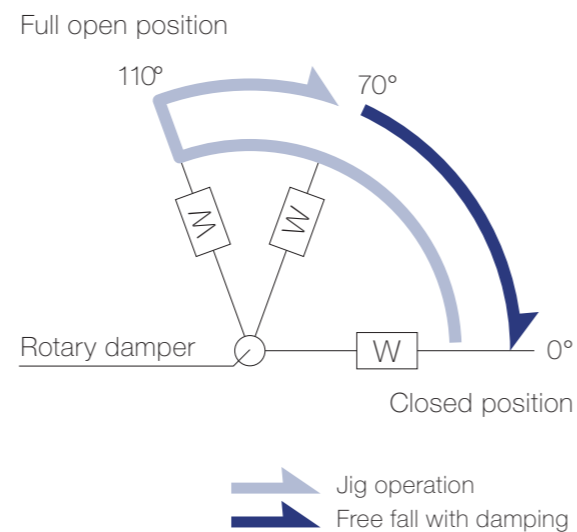

Inspection specification before shipping

Type	Preset torque [N·m] (lb·in)	Closing time
7K	0.7 (6.2)	3 to 12 sec

Product information

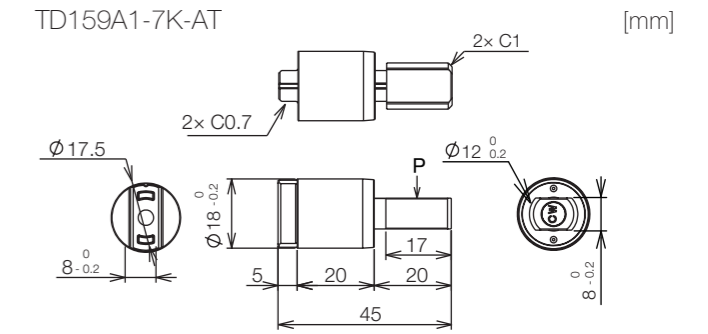
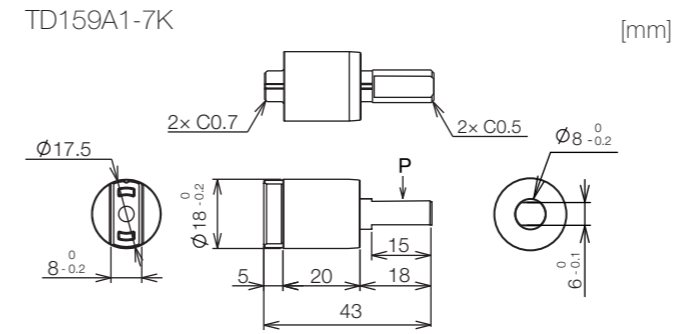

* General tolerance: ±0.3

- Opening angle: 280°
- Product weight: Approx. 30 g
- Allowable radial load (P): 29.4 N

Main materials

Housing	Zinc alloy(ZDC)
Ring screw	Zinc alloy(ZDC)
Shaft	Zinc alloy(ZDC)

Dimensions related to mounting

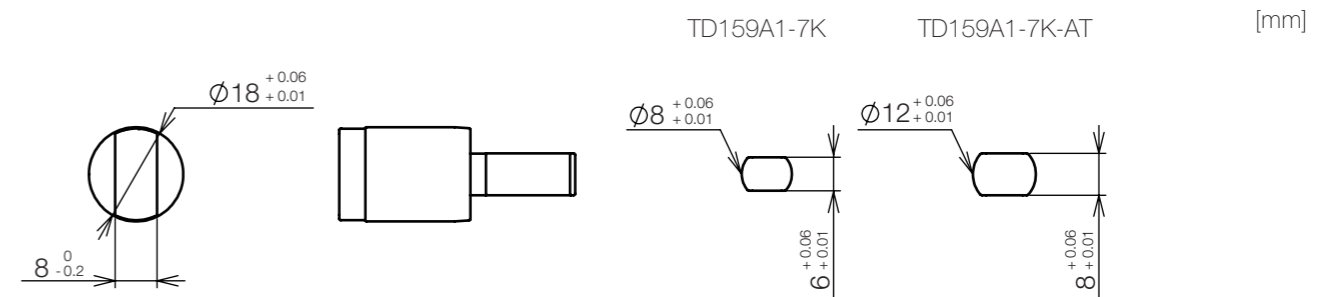

Opening angle

TD159A

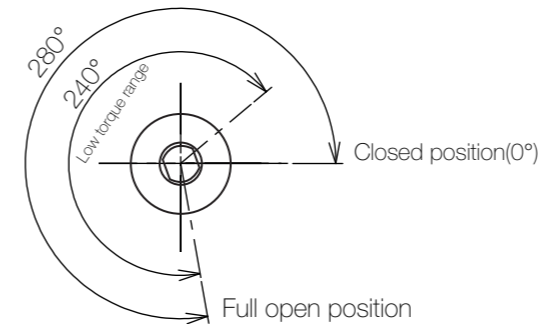

TD159A-AT

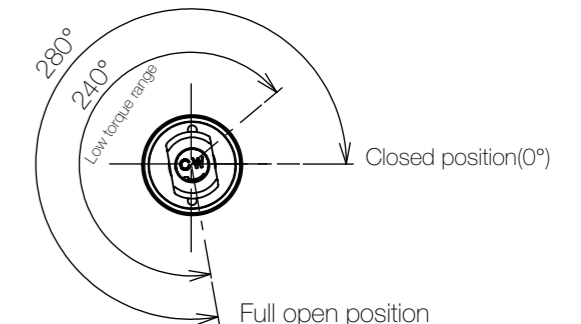

* Shaft position at the time of shipping: Closed position

Damping directions

Rotation directions of the shaft to which torque is applied

